

General Information About Ordering Specialty Heads

Points to Consider

Covering the Heads of Vessels and Tanks with insulation is always a challenge. Cook Brothers fabricates Heads and Cones from Trymer/XPS and Foamglas® material. There are three basic head configurations:

1. 2:1 Elliptical Heads
2. Flanged and Dished Heads (F&D)
3. Hemi-Spherical Heads

Regardless of the shape, it is extremely important to provide Cook Brothers with an accurate drawing of the Head with all the required dimensions. Tank Manufacturer and Drawing NO. are required. Drawing dimensions do not always reflect actual installation dimensions. Cook Brothers accepts no responsibility for fabricating heads based on manufacture drawings that do not represent actual construction.

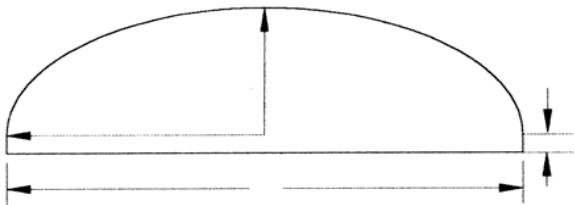

2:1 Elliptical Head

D = Tank Diameter
A = D/2 (Major Axis)
B = A/2 (Minor Axis)
L = Straight Flange

Flanged & Dished Head (F&D)

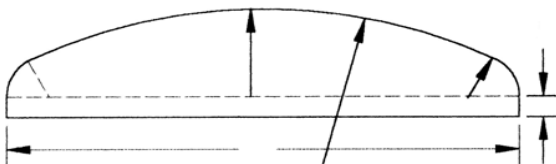

Flanged & Dished Head (F&D)

D = Tank Diameter
H = Height above Tangent
CR = Dish or Crown Radius
(80% to 100% D)
KR = Knuckle Radius
(0% to 20% D)
L = Straight Flange

Hemi-Spherical Head

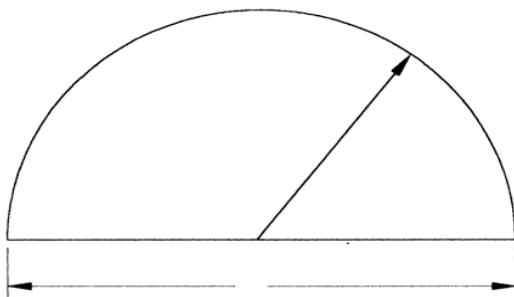

Hemi-Spherical Head

D = Diameter
R = Radius (D/2)

Note: Some F & D Heads look like 2:1 Elliptical Heads with CR = 80% D & KR = 10% to 20% D